

I.D. No. 24513

B.Tech. 7th.Semester F. Scheme Civil Engineering-XI

Examination, May-2014

ESTIMATING AND COSTING

Paper-CE-405-F

Time allowed: 3 hours]

[Maximum marks : 100

Note : (i) *Question No. 1 is compulsory.*

(ii) *All questions carry equal marks.*

(iii) *Attempt one question from each unit.*

(iv) *Assume missing data, if any, suitably.*

1. (a) Define the principle of estimate.
- (b) What are the general items for building construction ?
- (c) Describe the necessity of specifications.
- (d) Define detailed specification of earthwork.
- (e) Describe examination and payment of bills ?
- (f) What do you mean by "Salvage value"?
- (g) Briefly describe the procedure for cancellation of any entry in M.B.
- (h) What do you mean by rate analysis ?
- (i) What are the different methods of estimation ?
- (j) Define earnest money and retention money.

$2 \times 10 = 20$

I.D. No. 24513-P-4-Q-9 (14)

[P.T.O.]

Section-A

2. (a) Write different types of estimate. Explain any one. 10
(b) What are the Methods adopted to calculate Earthwork of Roads ? Explain with Sketches. 10
3. (a) Calculate the details of measurement and quantity of two rooms of given figure by using Centre Line Method ?

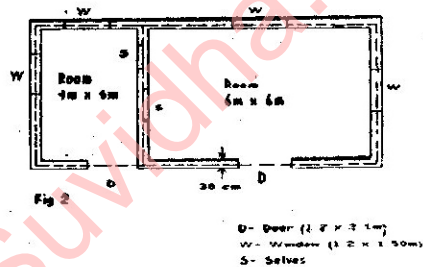
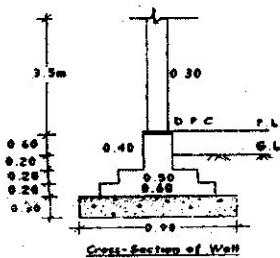

- (b) What are methods used for calculating the earthwork in case of canals and dams. 5

Section-B

- 4.**
- (a) Write specifications of the following items :
- | | | |
|--------|----------------|----|
| Bricks | Cement | |
| Sand | Water and lime | 10 |
- (b) Differentiate between 1st class, 2nd class and 3rd class buildings. 10

5. Write the detailed specification of D.P.C., cement plastering, earthwork for foundation and finishing. 20

Section-C

6. (a) What is the importance of rate analysis ? Explain the procedure of rate analysis for the following items :

Earth work

Concrete work

Reinforced brick work. 10

- (b) Prepare detailed analysis of rate for brickwork in cement mortar 1:6 in superstructure.

Labour required for 30 Cum of brickwork is

Mason-27 Nos. and

Labourers-60 Nos.

Rates of materials and labours may be assumed suitably. 10

7. (a) Write the units of measurement and mode of measurement of different items of work. 10

- (b) Estimate the quantity and cost for R.C.C. work in beam, slab etc. 1:2:4 - unit 100 cum. Assume suitable data. 10

(4)

I.D. No. 24513

Section-D

8. What are the different methods of valuation ? Explain each in detail. 20
9. (a) What are the different types of contracts ? Write advantage and disadvantage of any two types of contracts. 10
- (b) What is the procedure for the measurement of work for payment of contractors ? Explain in detail the different types of payments made to the contractor. 10